

**ABLE**  
ASTHMA



FR1MA1

# Touchless Forehead Thermometer



Alarm  
beep



30 data  
memory



Switchable



Light



Multi-  
functional



Mercury  
free



# Touchless Forehead Thermometer

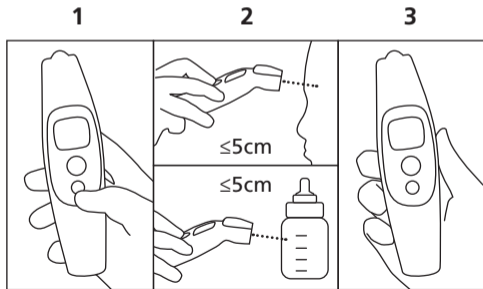

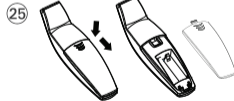
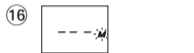
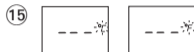
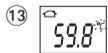
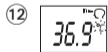
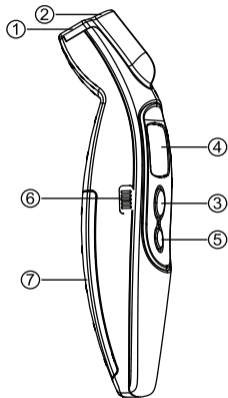

- ① Measuring sensor
- ② Tracking light
- ③ START button
- ④ Display
- ⑤ ON/OFF button
- ⑥ Mode switch
- ⑦ Battery compartment cover
- ⑧ All segments displayed
- ⑨ Memory
- ⑩ Ready for measuring
- ⑪ Measurement complete
- ⑫ Body mode
- ⑬ Object mode
- ⑭ Low battery indicator
- ⑮ Changing between Celsius and Fahrenheit
- ⑯ Recall mode
- ⑰ Recall the last 30 readings
- ⑱ Measured temperature too high

- ⑲ Measured temperature too low
- ⑳ Ambient temperature too high
- ㉑ Ambient temperature too low
- ㉒ Error function display
- ㉓ Blank display
- ㉔ Flat battery
- ㉕ Replacing the battery



Read the instruction manual carefully before using this device, especially the safety instructions, and keep the instruction manual for future use.



Type BF applied part



Keep dry

This touchless thermometer is a high quality product incorporating the latest technology and tested in accordance with international standards. With its unique technology, this device can provide a stable, heat-interference-free reading with each measurement. The device performs a self-test every time it is switched on to always guarantee the specified accuracy of any measurement.

This touchless thermometer is intended for the periodic measurement and monitoring of human body temperature.

**This thermometer has been clinically tested and proven to be safe and accurate when used in accordance to the operating instruction manual.**

Please read through these instructions carefully in order for you to understand all functions and safety information.

## Table of Contents

1. Advantages of this Thermometer
2. Important Safety Instructions
3. How this Thermometer measures Temperature
4. Control Displays and Symbols
5. Changing between Body and Object Mode
6. Directions for Use
7. Changing between Celsius and Fahrenheit
8. How to recall 30 readings in Memory Mode
9. Error Messages
10. Cleaning and Disinfecting
11. Battery Replacement
12. Guarantee
13. Technical Specifications
14. [www.ableasthma.com.au](http://www.ableasthma.com.au)  
Guarantee Card (see Back Cover)

### 1. Advantages of this Thermometer

---

#### Measures in 1 second

The innovative infrared technology allows the measurement without even touching the object. This guarantees safe and sanitary measurements within 1 second.

#### Multiple uses (wide range of measurement)

This thermometer offers a wide range of measurement from 0 - 100.0 °C / 32.0 - 212.0 °F, meaning the unit can be used to measure body temperature or it also has a feature allowing it to be used to measure surface temperature of the following examples:

- Milk surface temperature in a baby's bottle
- Surface temperature of a baby's bath
- Ambient temperature

#### Accurate and reliable

The unique probe assembly construction incorporates an advanced infrared sensor, ensuring that each measurement is accurate and reliable.

#### Gentle and easy to use

- The ergonomic design enables simple and easy use of the thermometer.
- This thermometer can even be used on a sleeping child without causing any interruption.
- This thermometer is quick, therefore child-friendly.

#### Auto-Display Memory

The last reading is automatically displayed for 2 seconds when the unit is switched ON.

#### Multiple readings recall

Users will be able to recall the last 30 readings when entering the recall mode, enabling efficient tracking of temperature variations.

#### Safe and hygienic

- No direct skin contact.
- No risk of broken glass or mercury ingestion.
- Completely safe for use on children.
- Cleaning of the probe can be done with an alcohol-moistened cotton tissue, making this thermometer completely hygienic for use by the whole family.

#### Fever alarm

10 short beeps and a red LCD backlight alert the patient that he/she may have a temperature equal to or higher than 37.5 °C.

### 2. Important Safety Instructions

---

- This device may only be used for the purposes described in these instructions. The manufacturer cannot be held liable for damage caused by incorrect application.
- **Never immerse this device in water or other liquids. For cleaning please follow the instructions in the 'Cleaning and Disinfecting' section.**

- Do not use this device if you think it is damaged or notice anything unusual.
- Never open this device.
- A basic physiological effect called vasoconstriction can occur in the early stages of fever, resulting in a cool skin effect. The recorded temperature using this thermometer can, therefore, be unusually low.
- If the measurement result is not consistent with the patient's finding or unusually low, repeat the measurement every 15 minutes or double check the result by another core body temperature measurement.
- This device comprises sensitive components and must be treated with caution. Observe the storage and operating conditions described in the «Technical Specifications» section.
- Ensure that children do not use this device unsupervised; some parts are small enough to be swallowed.
- Do not use this device close to strong electromagnetic fields such as mobile telephones or radio installations. Keep a distance from such devices when using this unit.
- Protect it from:
  - extreme temperatures
  - impact and dropping
  - contamination and dust

- direct sunlight
  - heat and cold
- If the device is not going to be used for a prolonged period the batteries should be removed.



**WARNING:** Use of this device is not intended as a substitute for consultation with your physician. This device is NOT waterproof so do not immerse in liquids.

### 3. How this Thermometer measures Temperature

This thermometer measures infrared energy radiated from the forehead as well as objects. This energy is collected through the lens and converted to a temperature value.

### 4. Control Displays and Symbols

- **All segments displayed** (8): Press the ON/OFF button (5) to turn on the unit; all segments will be shown for 2 seconds.
- **Memory** (9): The last reading will automatically be shown on the display for 2 seconds.
- **Ready for measuring** (10): When the unit is ready for measuring, the «°C» or «°F» icon will keep flashing while the mode icon (body or object) will be displayed.

- **Measurement complete** (11): The reading will be shown on the display (4) with the «°C» or «°F» icon and the mode icon steady. The unit is ready for the next measurement as soon as the «°C» or «°F» icon is flashing again.
- **Low battery indicator** (14): When the unit is turned on, the «▼» icon will keep flashing to remind the user to replace the batteries.

### 5. Changing between Body and Object Mode

For changing from body to object mode, slide the mode switch (6) at the side of the thermometer downwards. For switching back to body mode, slide the switch up again.

### 6. Directions for Use

#### Measuring in body mode

1. Press the ON/OFF button (5). The display (4) is activated to show all segments for 2 seconds.
2. The last measurement reading will automatically be shown on the display for 2 seconds with the «M» icon (9).
3. When the «°C» or «°F» icon is flashing, a beep sound is heard and the thermometer is ready for measuring (10).
4. **Aim the thermometer at the center of the forehead with a distance of no more than 5 cm.** Please remove

any hair, sweat or dirt from the forehead before measuring to improve the accuracy of the readings.

5. **Press the START button ③ and steadily position the thermometer** pointing to the temple area (about 1 cm above the eyebrow). The activated blue tracking light will indicate the area being measured. After 1 second a long beep will verify the completion of measurement.
6. Read the recorded temperature from the LCD display.

#### Measuring in object mode

1. Follow steps 1-3 above, then aim the thermometer at the center of the object you want to measure with a distance of no more than 5 cm. Press the START button ③. After 1 second a long beep will verify the completion of measurement.
2. Read the recorded temperature from the LCD display.

#### NOTE:

- **Patients and thermometer should stay in similar room condition for at least 30 minutes.**
- Don't take a measurement while or immediately after nursing a baby.
- Don't use the thermometer in high humidity environments.
- Patients should not drink, eat or exercise before/while taking the measurement.
- Don't move the measurement device from the

measuring area before hearing the termination beep.

- Use an alcohol swab to carefully clean the probe and wait for 15 minutes before taking a measurement on another patient.
- 10 short beeps and a red LCD backlight alert the patient that he/she may have a temperature equal to or higher than 37.5 °C.
- Always take the temperature in the same location, since temperature readings may vary according to locations.
- Doctors recommend rectal measurement for newborn infants within the first 6 months, as all other measuring methods might lead to ambiguous results. If using a non contact thermometer on those infants, we always recommend verifying the readings with a rectal measurement.
- In the following situations it is recommended that three temperatures are taken with the highest one taken as the reading:
  1. Children under three years of age with a compromised immune system and for whom the presence or absence of fever is critical.
  2. When the user is learning how to use the thermometer for the first time until he/she has familiarized himself/herself with the device and obtains consistent readings.
  3. If the measurement is surprisingly low.

- **Readings from different measuring sites should not be compared as the normal body temperature varies by measuring site and time of day**, being highest in the evening and lowest about one hour before waking up.

Normal body temperature ranges:

- Axillar: 34.7 - 37.3 °C / 94.5 - 99.1 °F
- Oral: 35.5 - 37.5 °C / 95.9 - 99.5 °F
- Rectal: 36.6 - 38.0 °C / 97.9 - 100.4 °F
- Microlife NC 100: 35.4 - 37.4 °C / 95.7 - 99.3 °F

#### 7. Changing between Celsius and Fahrenheit

This thermometer can display temperature readings in either Fahrenheit or Celsius. To switch the display between °C and °F, simply turn OFF the unit, **press and hold** the START button ③ for 5 seconds; after 5 seconds, the current measurement scale («°C» or «°F» icon) will flash on the display ⑮. Change the measurement scale between °C and °F by pressing the START button ③. When the measurement scale has been chosen, wait for 5 seconds and the unit will automatically enter the «ready for measuring» mode.

#### 8. How to recall 30 readings in Memory Mode

This thermometer can recall the last 30 readings.

- **Recall mode** (16): Press the START button (3) to enter Recall mode when power is off. The memory icon «M» will flash.
- **Reading 1 - the last reading** (17): Press and release the START button (3) to recall the last reading. Display 1 alone with memory icon.
- **Reading 30 - readings in succession:** Press and release the START button (3) consecutively to recall the last 30 readings in succession.

Pressing and releasing the START button (3) after the last 30 readings have been recalled will resume the above sequence from reading 1.

## 9. Error Messages

- **Measured temperature too high** (18): Displays «H» when measured temperature is higher than 42.2 °C / 108.0 °F in body mode or 100 °C / 212 °F in object mode.
- **Measured temperature too low** (19): Displays «L» when measured temperature is lower than 34.0 °C / 93.2 °F in body mode or 0 °C / 32 °F in object mode.
- **Ambient temperature too high** (20): Displays «H» and ☰ when ambient temperature is higher than 40.0 °C / 104.0 °F.
- **Ambient temperature too low** (21): Displays «L» and ☰ when ambient temperature is lower than 16.0 °C /

60.8 °F in body mode or lower than 5.0 °C / 41.0 °F in object mode.

- **Error function display** (22): The system has a malfunction.
- **Blank display** (23): Check if the batteries have been inserted correctly. Also check polarity (<+> and <->) of the batteries.
- **Flat battery indicator** (24): If only «▼» icon is shown on the display, the batteries should be replaced immediately.

## 10. Cleaning and Disinfecting

Use an alcohol swab or cotton tissue moistened with alcohol (70% Isopropyl) to clean the thermometer casing and the measuring sensor. Ensure that no liquid enters the interior of the device. Never use abrasive cleaning agents, thinners or benzene for cleaning and never immerse the device in water or other cleaning liquids. Take care not to scratch the surface of the sensor lens and the display.

## 11. Battery Replacement

This device is supplied with 2 new, long-life 1.5V, size AAA batteries. Batteries need replacing when this icon «▼» (24) is the only symbol shown on the display.

Remove the battery cover (25) by sliding it in the direction shown.

Replace the batteries – ensure correct polarity as shown by the symbols in the compartment.



Batteries and electronic devices must be disposed of in accordance with the locally applicable regulations, not with domestic waste.

## 12. Guarantee

This device is covered by a **2 year guarantee** from the date of purchase. The guarantee valid only on presentation of the guarantee card completed by the dealer (see back) confirming date of purchase or the receipt.

- The guarantee covers the device. Batteries and packaging are not included.
- Opening or altering the device invalidates the guarantee.
- The guarantee does not cover damage caused by improper handling, discharged batteries, accidents or non-compliance with the operating instructions.

Please contact Able Asthma.



### 13. Technical Specifications

<b>Type:</b>	Non Contact Thermometer FR1MA1
<b>Measurement range:</b>	Body mode: 34.0-42.2 °C / 93.2-108.0 °F Object mode: 0-100.0 °C / 32-212.0 °F
<b>Resolution:</b>	0.1 °C / °F
<b>Measurement accuracy:</b>	Laboratory: ±0.2 °C, 36.0 – 39.0 °C ±0.4 °F, 96.8 – 102.2 °F
<b>Display:</b>	Liquid Crystal Display, 4 digits plus special icons
<b>Acoustic:</b>	The unit is turned ON and ready for the measurement: 1 short beep. Complete the measurement: 1 long beep (1 sec.) if the reading is less than 37.5 °C / 99.5 °F, 10 short «beep» sounds, if the reading is equal to or greater than 37.5 °C / 99.5 °F. System error or malfunction: 3 short «bi» sounds.
<b>Memory:</b>	Auto-Display the last measured temperature 30 readings recall in the memory mode

**Backlight:** The display light will be GREEN for 4 seconds, when the unit is turned ON. The display light will be GREEN for 5 seconds, when a measurement is completed with a reading less than 37.5 °C / 99.5 °F. The display light will be RED for 5 seconds, when a measurement is completed with a reading equal to or higher than 37.5 °C / 99.5 °F.

**Operating conditions:** Body mode: 16-40.0 °C / 60.8-104.0 °F  
Object mode: 5-40.0 °C / 41-104.0 °F

**Storage conditions:** -20 - +50 °C / -4 - +122 °F  
15-95 % relative maximum humidity

**Automatic Switch-off:** Approx. 1 minute after last measurement has been taken.

**Battery:** 2 x 1.5 V alkaline batteries; size AAA

**Battery life-time:** approx. 2000 measurements (using new batteries)

**Dimensions:** 150 x 40 x 39 mm

**Weight:** 81 g (with batteries), 56 g (w/o batteries)

**IP Class:** IP21: Protected against solid foreign objects of 12.5mm diameter and greater. Protected against the ingress of vertically falling water drops with the device positioned on a turntable.

**Reference to standards:** ASTM E1965;  
IEC 60601-1; IEC 60601-1-2 (EMC);  
IEC 60601-1-11

**Expected service life:** 5 years or 12000 measurements

This device complies with the requirements of the Medical Device Directive 93/42/EEC. Technical alterations reserved. According to the Medical Product User Act a biennial technical inspection is recommended for professional users. Please observe the applicable disposal regulations.

#### Touchless Forehead Thermometer

Manufacturer: ONBO Electronic (Shenzhen) Co., Ltd.  
No. 497 Ta Laneg Nan Road, Ta Laneg Street,  
Longhua New District, Shenzhen, China  
Registration owner and importer: WyMedical Pty Ltd  
466 Fullarton Road, Myrtle Bank, South Australia 5064  
Customer service: Australia 1800 812 097